

### Design

- Annular Rubber Ring
- Inner Metal Core with tapped hole to take bolt from supporting machinery
- Outer Metal Ring with holes provided for bolt in wherever required
- Protruding Rubber Ring acting as a non-skid pad for direct floor mounting without fastening bolts
- Plated steel cap for oil & corrosion protection



### Advantages

- Eliminates upto 98% Vibrations
- Accepts Large Transitory Shocks
- 2-3 Times Stiffer Radially than Axially
- Quick and Easy Installation
- Fixing by bolts and rebound stop facility for Mobile Application
- Oil & Corrosion Protection



### Typical Applications

- Extensively used for supporting Engine and Operator Cabin in Hydraulic Excavators and other Earth Moving Machinery.
- Support Large Motor Compressor Units, Naval Application, Generators, Tanks, Diesel Engines, Reducers etc. on ground and mobile equipment.
- Used under Metal Working Machinery. Textile Machinery, Refrigeration & Air Conditioning Equipment.

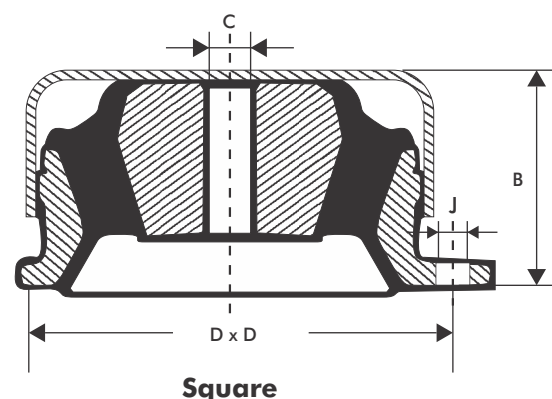
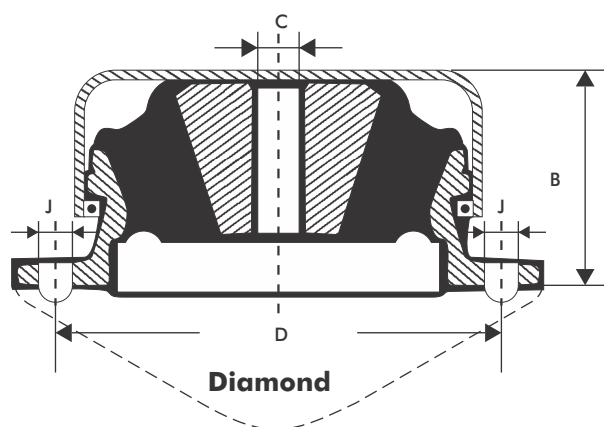

### Characteristics

Type	Shore 'A'							Physical			
	50		60		70			Height	Threaded	Centres	Hole
Part No.	Load.	Defl.	Load.	Defl.	Load.	Defl.	Base	B	C	D	Dia. x no.
	lbs	inch	lbs	inch	lbs	inch		(inch)	(inch)	(inch)	(inch) x nos.
STB 0069	66	0.12	50	0.12	70	0.12	Diamond	1.61	M - 0.47	3.86	0.35 x 2
STB 0084	176	0.16	130	0.16	175	0.16	Diamond	2.01	M - 0.47	4.53	0.43 x 2
STB 0100	407	0.12	300	0.12	400	0.12	Square	2.05	M - 0.47	3.54 x 3.54	0.43 x 4
STB 0133	990	0.20	725	0.20	1000	0.20	Square	2.83	M - 0.63	4.49 x 4.49	0.51 x 4
COLOUR	Green		Blue		Red						